



Our Nature: Your Tees - Local Partnerships Conference

Friday 16th June, Preston Hall Museum Stockton-on-Tees

| Time | 9.30 – 10.00am Registration & Refreshments | Location |
|-------|---|--------------|
| 10.00 | Arrive, welcome & introductions to the partnerships & the day | Music Room |
| 10.30 | Theme: Natural Assets Dr Garry Weeks; Head of Science & his team at Teesside Uni | Music Room |
| 10.45 | Workshops & presentations | |
| | <i>Honey Bees & Pollination: Threats & Opportunities.</i> John Canning CBKA/Tees Bees | Music Room |
| | <i>Tackling Invasive Species on the Tees</i> John Musham , Tees Rivers Trust | Demo kitchen |
| | <i>The Increasing Role of Volunteers & Friend's Groups in the Management of Green Spaces - issues challenges & possibilities.</i> Dr Sue Antrobus – TV Wild Green Places | Billiard Rm |
| | <i>Tees Valley Wide Green Infrastructure Planning & Application.</i> Tim Crawshaw , Built & Natural Environment Manager Darlington Borough Council | Meeting Rm |
| 11.20 | Vote on the TVNP medium-term priorities | Music Room |
| 11.30 | Tea & coffee break | |
| 11.45 | Theme: Natural Growth Linda Tuttiett; Head of Culture & Tourism Combined Authority . | Music Room |
| 12.00 | Workshops & presentations | |
| | <i>Developing a Habitat Framework for the Tees Estuary – New Opportunities for Nature</i> Dr Robert Woods Industry Nature Conservation Association | Music Room |
| | <i>Finding & Applying for Funding</i> Chris Barlow , ERS | Billiard Rm |
| | <i>Natural Capital - outcomes of the LEED workshop held with the Combined Authority</i> Graeme Hull , Environment Agency | Meeting Rm |
| | <i>Community Engagement, Partnership & Leadership – what are they and what do we want?</i> Paul Cobbing , National Flood Forum | Demo kitchen |
| 12.35 | Vote on the TVNP medium-term priorities | Music Room |
| 12.45 | FREE Lunch & market place: Tees Bees; Friends of Fairy Dell; Cleveland Hedgehog Preservation Soc; Campaign Preservation Rural England; Tees Valley Wildlife Trust; Northumbrian Water; River Tees Re-discovered... | |
| 1.30 | PechaKucha presentations: River Tees Re-discovered Lucy Chapman . <i>Small Sites & Pocket Parks a River Skerne example</i> , Paul Harman , Friends of the River Skerne. One Planet Pioneers Nicky Morgan , Middlesbrough Environment City. <i>Peatland Restoration in the Upper Tees and the Benefits Downstream</i> Paul Leadbitter , North Pennines AONB Partnership ; | Music Room |
| 2.15 | Theme: Natural Health & Wellbeing Denise Orange; Health Improvement Manager Public Health England | Music Room |
| 2.30 | Workshops & presentations | |
| | <i>Friends of Fairy Dell – making the link with H & WB in their green space.</i> With a short Tai Chi session outside Craig Postgate , Middlesbrough Borough Council | Music Room |
| | <i>Organic Farming, Local Food & Our Health & Wellbeing</i> Roberto Romano , Clervaux Trust | Demo kitchen |
| | <i>Social Prescribing, what is it & The Role/Opportunities in Nature</i> Gemma Clifford , Health & Wellbeing Lead - Catalyst, Stockton | Meeting Rm |
| | <i>The Contribution of the Natural Environment to Tackling Health Inequalities</i> Claire Spence , Health Improvement Specialist at Stockton Borough Council | Billiard Rm |
| 3.05 | Vote on the TVNP medium-term priorities | Music Room |
| 3.15 | What now, thank-you & Close | Music Room |



Our Nature; Your Tees - Local Partnerships Conference
Friday 16th June, Preston Hall Museum Stockton-on-Tees

VICTORIAN STREET WORKSHOPS:
 DEMO KITCHEN (turn right)
 MEETING RM. (turn left)

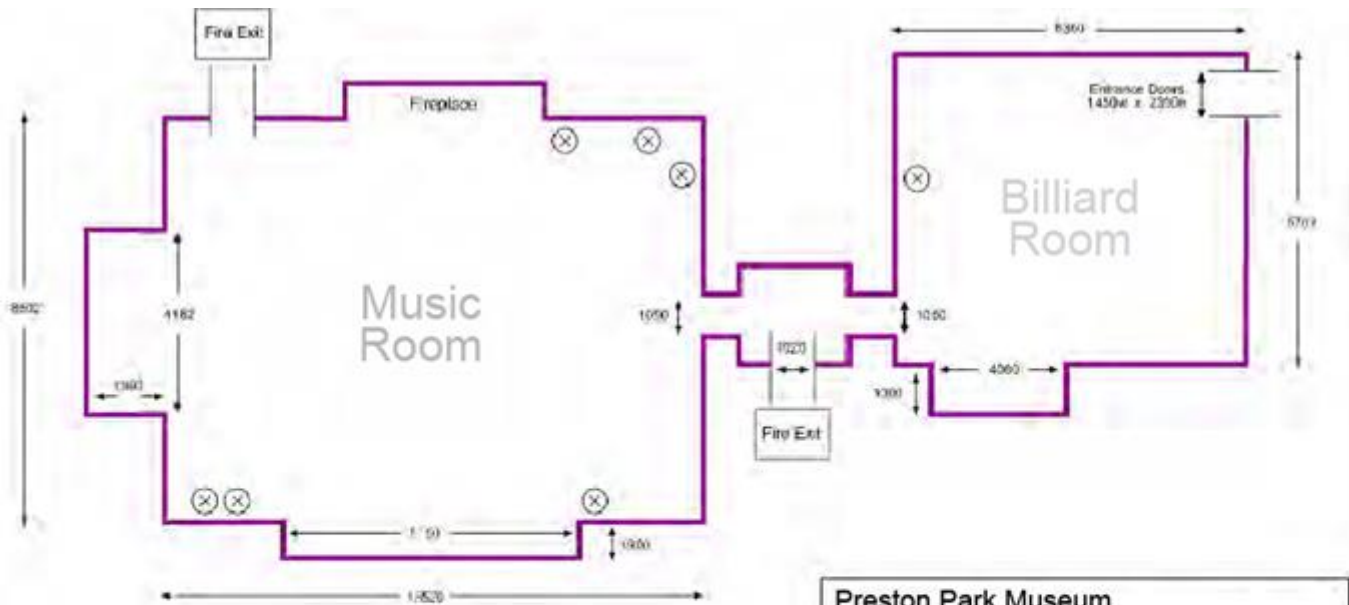

**Preston Park Museum
 Music Room & Billiard Room Suite**

All sizes are approximate and for indication only

⊗ Power points 240v

